

# TECHNICAL DATA SHEET

# Waterproofing Paste

27/05/26

A highly flexible, waterproof, liquid membrane

## Key Features

- Protects moisture-sensitive wall and floor backgrounds prior to tiling
- Ready to use to for a single-coat application
- Creates a highly flexible, waterproof barrier
- Rapid-drying - fix tiles after just 3 hours



## Technical Information

Pack sizes	2.5kg & 7.5kg
Colour	Light Grey
Application temperature (air and background)	≥ 5°C
Application thickness	Approximately 1mm
Tile after (@20°C)	3 hours
Consumption per mm thickness	0.38kg/m <sup>2</sup>
Approximate coverage	Up to 3.2m <sup>2</sup> / kg

## Areas of Use

Walls and Floors	Interior	Domestic and Commercial	Showers	Wet Rooms
------------------	----------	-------------------------	---------	-----------

## Suitable Wall Backgrounds

Cement:Sand Render	Plaster (Finish Coat)	Plasterboard	Tile Backer Boards
--------------------	-----------------------	--------------	--------------------

## Suitable Floor Backgrounds

Cement:Sand Screed (inc. Heated)	Concrete	Calcium Sulphate/ Anhydrite Screed (inc. Heated)	Existing Ceramic, Porcelain, and Natural Stone Tiles	Tile Backer Boards
----------------------------------	----------	--	--	--------------------

## Background and Surface Preparation

Backgrounds must be sufficiently dry and strong enough to carry the total weight being applied. Ensure falls in the substrate have the required gradients and all drainage is capable of efficiently handling the expected rate of water flow. All surfaces must be clean, sound, flat and free from contaminants that could impair adhesion, such as dust, dirt, oil, grease, laitance, and curing agents. Timber bases must be rigid, stable and adequately ventilated. They should support both static and dynamic loads without deflection and be covered with an appropriate intermediate layer.

Very porous backgrounds should be primed with one coat of PrimeMore Universal, diluted 1:3 with clean water. If preferred, other porous backgrounds may also be primed using the same dilution. In all cases, allow the primer to dry fully before applying Waterproofing Paste.

## Guidance Notes on Suitable Wall Backgrounds

### CEMENT:SAND RENDER

- Must be true and firmly bonded.
- New render must be prevented from rapid drying and be allowed to air dry for at least 2 weeks.

### PLASTER

- Tiles should only be fixed to a finish coat of plaster.
- Ensure it is dry, sound, free from any loose or weak material and well adhered.
- If both a backing coat and finish coat have been applied, allow to dry for a minimum of 4 weeks.
- Overly trowelled plaster should be brushed down with a stiff brush.
- Maximum permitted tiling weight is 20kg/m<sup>2</sup>.

### PLASTERBOARD

- Boards fixed to stud frames must be the correct thickness, securely fixed and rigid.
- For boards bonded to solid walls, allow the board adhesive to fully set before tiling.
- Maximum permitted tiling weight is 32kg/m<sup>2</sup>.

### TILE BACKER BOARDS

- Ensure the boards are installed as instructed by the manufacturer.
- Boards fixed to stud frames must be the correct thickness, securely fixed and rigid.
- For boards bonded to solid walls, allow the adhesive to fully set before tiling, and use mechanical fixings where specified by the manufacturer.
- Proprietary boards have varying weight limits - consult the manufacturer for details.

## Guidance Notes on Suitable Floor Backgrounds

### CEMENT:SAND SCREED

- Allow new screeds to dry for at least 3 weeks.
- For proprietary screeds, follow the manufacturer's recommendations for preparation and drying times.

### HEATED CEMENT:SAND SCREED

- New screeds must be commissioned from 3 weeks after screed installation and before work commences.
- Heat slowly at a maximum rate of 5°C per day until the maximum operating temperature is reached. Hold this temperature for 3 days before allowing the screed to cool to room temperature.
- For proprietary screeds, follow the manufacturer's recommendations for commissioning and preparation.

### CONCRETE

- Allow new concrete to cure before being subjected to continuous air drying in good conditions for at least 6 weeks.
- Power floated concrete should be mechanically prepared to achieve a clean, sound, micro-textured, dust-free surface.

### CALCIUM SULPHATE/ANHYDRITE SCREEDS

- All laitance and surface contaminants must be completely removed.
- The screed must be confirmed sufficiently dry ( $\leq 75\% R$ ).

### HEATED CALCIUM SULPHATE/ANHYDRITE SCREEDS

- All laitance and surface contaminants must be completely removed.
- New heated screeds must be commissioned from 7 days after screed installation and before work commences.
- The screed should be heated slowly and in accordance with the recommendations of the screed manufacturer.
- The screed must be confirmed sufficiently dry ( $\leq 75\% RH$ ).

### EXISTING CERAMIC, PORCELAIN, AND NATURAL STONE TILES

- Must be in good condition, free from contaminants and well bonded to a subfloor containing an effective structural damp proof membrane.
- Ensure the existing structure can take the additional weight.

### TILE BACKER BOARDS

- Must be installed as instructed by the manufacturer and be securely fixed to rigid, suitable, prepared bases.
- Where boards have been installed on solid bases using tile adhesive, ensure the adhesive has fully set before commencing tiling.

## Application

Kelmore's Waterproofing Paste is ready to use and must be used in conjunction with Kelmore's reinforcing tape and preformed corners when waterproofing backgrounds. Please follow the application instructions below:

### 1. Fit the preformed corners.

- Apply Waterproofing Paste directly to the background, ensuring the area covered is slightly wider than the surface area of the preformed corner.
- Press the preformed corner firmly into the wet paste, ensuring it is fully embedded, sits flat, and has good contact. Remove any excess paste from the edges.
- Repeat this process until all preformed corners have been installed.

### 2. Tape all junctions, board joints, pipe outlets and fixing points.

- Starting with the junctions where the walls meet the floor, measure and pre-cut lengths of Reinforcing Tape, ensuring each piece overlaps any preformed corners by at least 30mm.
- Apply Waterproofing Paste to the background where the Reinforcing Tape will be embedded, extending over any preformed corners, and ensuring the coverage is slightly wider than the width of the tape.
- Press the tape firmly into the wet paste, ensuring it is fully embedded, sits flat, and has good contact. Remove any excess paste from the edges.
- Repeat this process until all junctions, board joints, pipe outlets and fixing points have been reinforced.

### 3. Apply one coat of Kelmore Waterproofing Paste.

- Using a medium pile roller or brush, apply the paste evenly across the entire area, including the surface of the tape and corners. Do not over apply - Waterproofing Paste should be applied as a thin, uniform coat of approximately 1mm, ensuring the background is no longer visible once dry.
- Allow to fully dry for at least 3 hours before tiling.

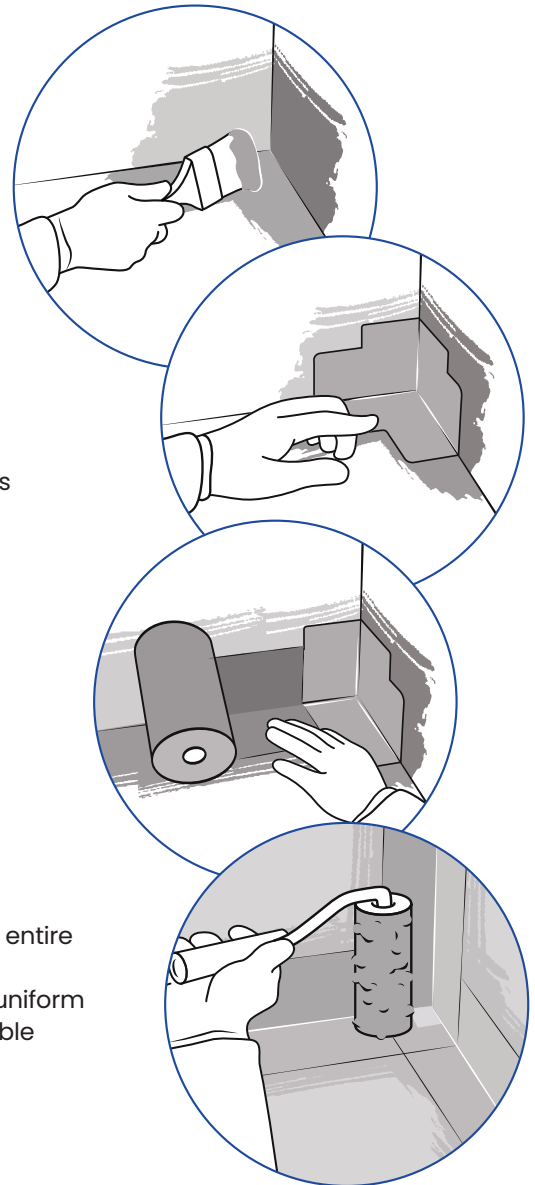

## Drying

Drying times will vary dependent on the porosity of the background, ambient temperature and humidity. When tested at 20°C, and with good airflow, Waterproofing Paste is dry and ready to receive tiles after 3 hours. Please be aware that lower temperatures, high humidity and a lack of airflow will extend the drying time.

### Notes:

- Kelmore Waterproofing Paste must only be used on dry, internal backgrounds and is not suitable in areas subject to rising damp or negative water pressure.
- Do not use in areas of total water immersion such as swimming pools and storage tanks.

**Cleaning:** All tools should be cleaned with water after use and before the product dries.

**Health and Safety:** For full details, please refer to the Safety Data Sheet, available at [www.kelmore.co.uk](http://www.kelmore.co.uk) or by contacting Kelmore Ltd.

**Storage and Shelf Life:** Must be protected from frost, and when stored in unopened packaging, off the ground, and in cool, dry conditions, this product has a shelf life of 12 months.

**BS & EN Standards:** Product should be used in accordance with the requirements of the relevant British and European Standards.

*All the information supplied by Kelmore Ltd is offered in good faith and is derived from the company's combined knowledge, experience and testing. Without prior notice, due to on-going research and development, the information we offer can be updated at any time. Kelmore's products are developed, tested and manufactured to consistently high standards, however, we accept no liability for any loss or damage which may arise from factors outside of our control, such as site conditions and/or the execution of the work.*